



# S-V95

## MULTI-STATION CART COMPACTOR

This solution allows you to compact directly into your existing rolling carts. Simply stage your carts in the frame, drop material into roller cart, slide compactor head over the cart, push the button and walk away. Eliminate unnecessary extra cans and extra pick-up days.

You can organize a complete miniature trash/recycling/organics station in a small footprint. Waste can be processed and conveniently sorted for immediate recycling, composting or disposal. Flexible design allows capacity to be tailored to requirements, but does not overload the carts.



### FEATURES

- Modular and durable
- Quiet operation
- Top loading
- Uses standard bins
- Easy and safe to use
- Compacts into 64 and 95 gallons

### BENEFITS

- Slash waste costs 35-75%
- Save space
- Simplify handling
- Improve workplace environment
- Increases diversion rate

manufactured by **summit**

### SPECIFICATIONS

Feed chamber opening	30"W x 30"D
Container capacity	95 gal carts/bins/totes
Cycle time	57 sec
Platen penetration	20"
Motor	1/2" HP
Line power	115 VAC 10, 9.4 FLA
Hydraulic pump	0.91 gpm gear
Line Pressure	700 pse operating; 1,000 (max)
Packing force	3,436 lbs typ; 4,909 lbs max
Platen face pressure	17 psi (typ); 24.4 psi (max)
Cylinder	2.5" x 24" x 1-3/8"
Safety shutdown	Mushroom-headed emergency STOP
System protection	Electrical & mechanical, manual & auto
Fluid reservoir	Supplied with breather & fluid
Dimensions	(3 Chamber) 105.75 w x 85.25 h"
Shipping weight	200 lbs
Certification	UL508A/CSA C22.2 No.14 or UL73

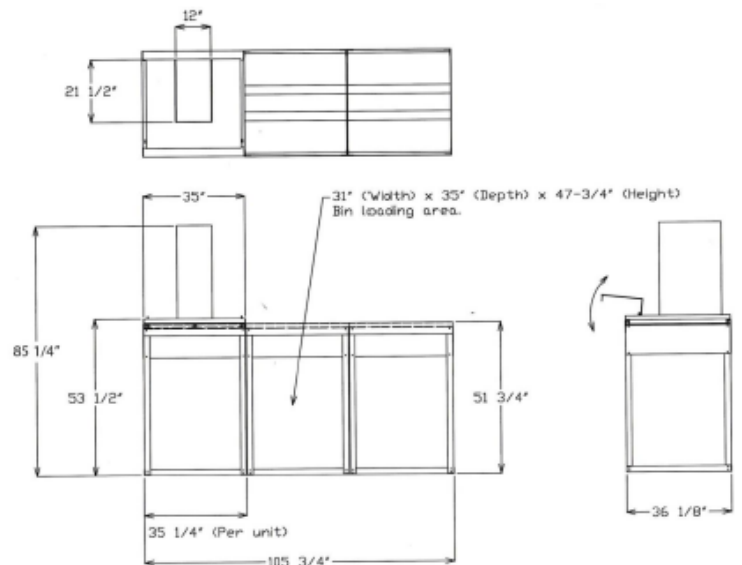

\*Specifications may vary **UL** US



(925) 465-5133 | [info@batc-compacts.com](mailto:info@batc-compacts.com) | [www.batc-compacts.com](http://www.batc-compacts.com)